

# Local Pioneer Cemeteries

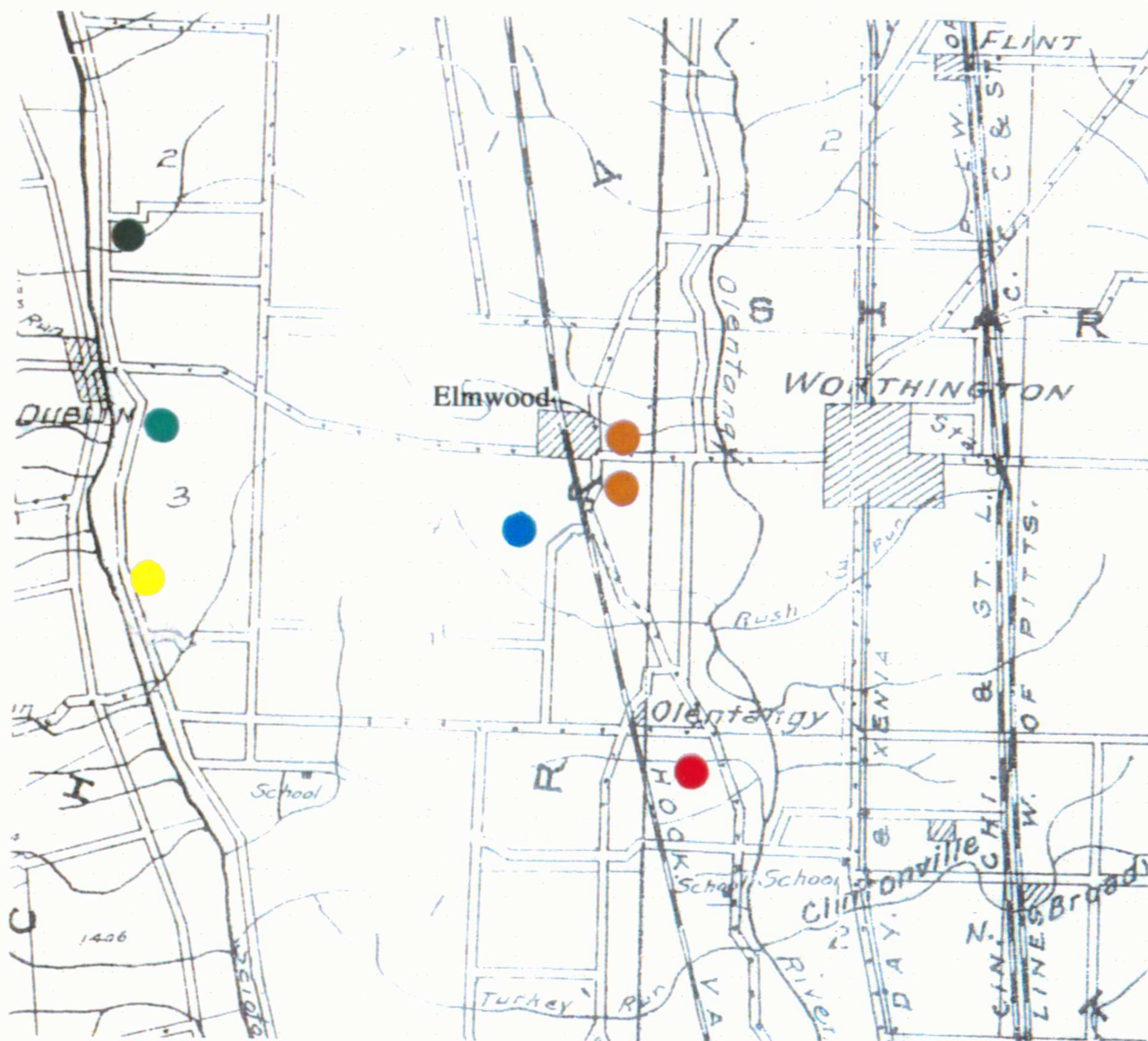

Perry Township was a farming territory in the early days of Franklin County. There were no village or church cemeteries; only family. Many of the early settlers who helped establish northern Perry Township and eventually Elmwood in 1877 were buried in these. Many sites have disappeared.

- Kempton cem. est. 1819
- Davis cem. est. 1823
- Ferris cem. est. 1848
- Deardorff cem. no date
- Wilcox cem. no date
- Family cem's. in Elmwood (no record of names)





Joseph Ferris came to Perry Township in 1818, where he met and fell in love with Sarah Smith. They were married in May, 1819, and settled on part of her parents' farm, a dense forest along the east bank of the Scioto River—now Riverside Drive and Bright Rd. In 1820 Joseph and Sarah built the first frame house in the upper Scioto River Valley. (Residence of Josephine Holder 2004)



Pictured examining broken tombstone is Josephine Holder, great-granddaughter of Joseph and Sarah Ferris, and Jim Thompson, co-chairman of LUMC Historical Society.



Historical Marker placed at abandoned cemetery site by Linworth United Methodist Church Historical Society. Pictured July 2004, kneeling L-R: Ray Sanborn, Jim Richards, Julia Slonecker; standing L-R: Ed Pollock, Jim Thompson and Janet Enck.

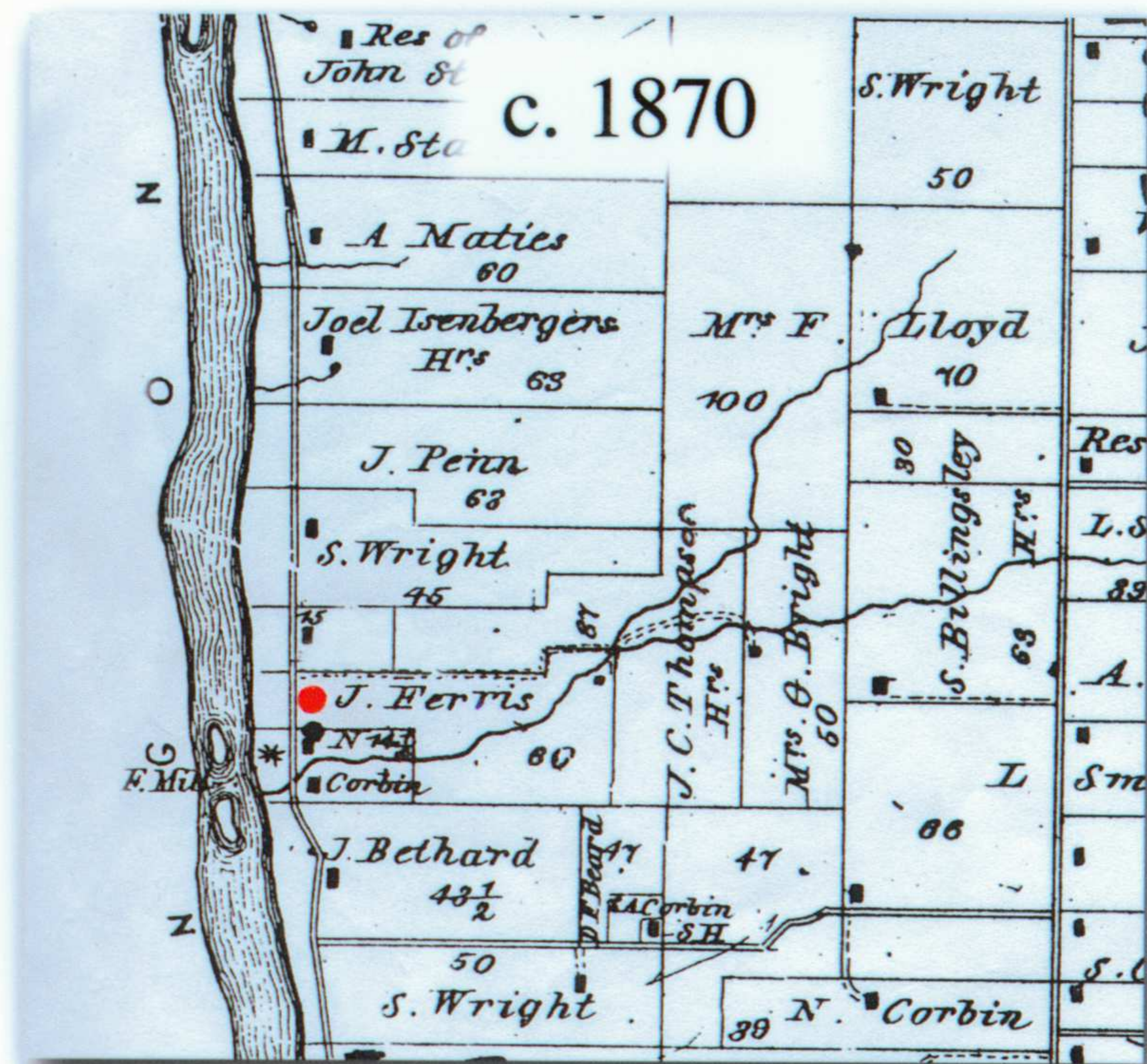

● Established in 1848, the Ferris Cemetery is located in the tree line along the western edge of the field, approx. 700 feet south of Bright Rd. on the east side of Riverside Dr. As recently as 1930, there were visible signs of at least 24 burial sites. Two confirmed burials are pioneer settlers David Smith and his wife, Elizabeth Gooding Smith.



Location of cemetery is behind grove of trees on Ohio State University property, w/o Godown Rd. - adjacent to Don Scott Airfield.



Jim Thompson was searching for traces of the abandoned Wilcox Cemetery in July 2002 when an Ohio State University employee uncovered a tombstone while grading and leveling farm land.

Sarah O.  
Daughter of J.  
W. and E.J.  
Michael died  
Sept. 21, 1854.  
One year, 3  
months, 24  
days.



Simeon Wilcox came west from Connecticut in 1803 to a wild unbroken forest in Perry Township where he built a cabin and established a home for his wife and children. His son, Tracy, assisted in clearing the land; and, in time the family extended the boundaries of the farm and became very successful.

In 1889, Tracy's sons, John and Washington W., along with residents from the Village of Elmwood, built a small one-room chapel. Today it is known as Linworth United Methodist Church.



Cemetery marker was made by Linworth Methodist Church Historical Society member Ed Pollock in 2003. Placing flowers for the 4th of July 2004 are members, L-R Ray Sanborn and Jim Thompson.

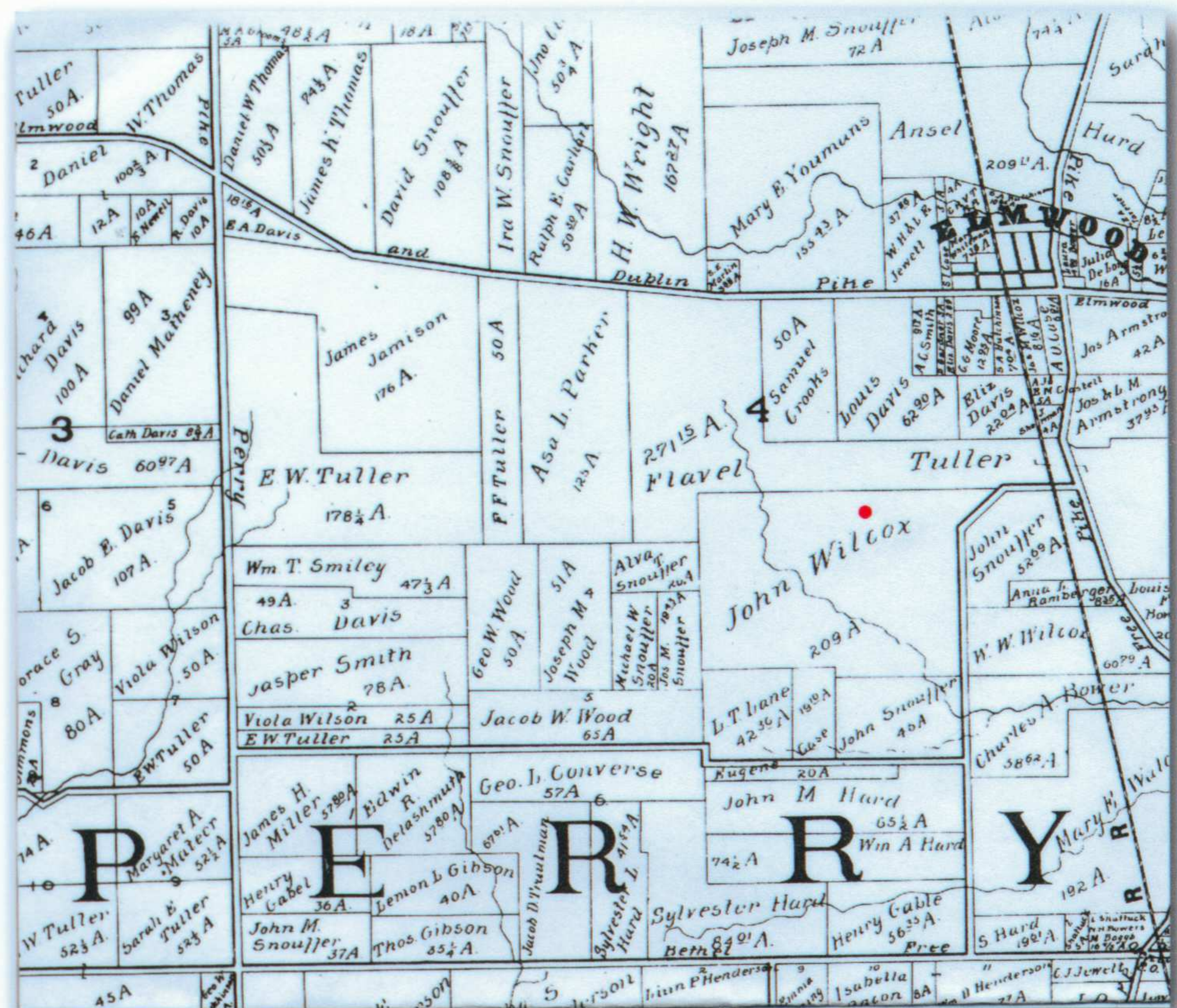

Map of Elmwood/Perry TWP. c. 1890

• Wilcox Cemetery